

TECHNICAL SPECIFICATIONS

Model	1144		
Supply voltage	220-240 V 50Hz		
Lamp Power (W)	2 x 50 W 2 x 25 W		
Control Type	Electronic Control Panel with digital indicator		
Engine Power (m³/h)	210 W		
Absorption power (m³/h)	800m³/h		
Flow (m³/h) (Position)	m³/h	1	290
		2	420
		3	800



KITCHEN HOODS

SLIDING BUILT-IN



1144

USER MANUAL

DESCRIPTION OF THE DEVICE

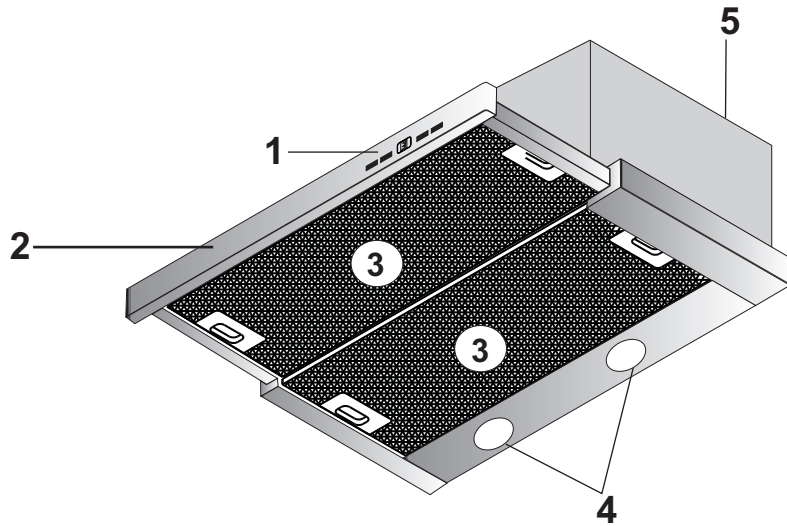

- 1)Control Panel
- 2)Front Panel
- 3)Aluminum cartridge oil filter
- 4)Cooking illumination
- 5)Aspirator plate body

	Check Electric connection. (See Security Introductions, Article 2) (Network voltage should be 220-240 V, Aspirator should be connected to earthed socket.)	Check motor switch. (Motor switch should be in open position.)	Check lamp switch. (Lamp switch should be in open position.)	Check aluminum filter. (Aluminum cassette filter should be washed once a month under normal conditions.)	Check bulbs. (Bulbs should be in good condition.)	Check air outlet chimney. (Air outlet chimney should be open.)	Check carbon filter. (If it operates with carbon filter, Carbon filter should be replaced quarterly.)
Aspirator does not operate	X	X					
Illumination lamp does not light	X		X		X		
Air suction of aspirator is weak				X		X	X
It does not exhaust air (in the ambient without chimney)				X			X

Table 1

If aspirator does not operate

Before contacting with the Service:

Be sure that plug is connected to the socket and electric fuse in the installation is in good condition, do not make any transaction, which shall damage the product. Before contacting with the Service, check your Aspirator according to **Table 1**. If problem continues, contact with your seller or the most authorized service.

Service and Spare Part:

You can supply spare parts of your product from your seller or your authorized service. There is an authorized service list with the product within the package. When you contact with your service or seller, inform model name of the product, which you can see on the product label, in order to demand spare part. When you remove aluminum cassette filter from its place, you can see the product label.

MAINTENANCE

- * Device must be unplugged before maintenance works. Before maintenance and cleaning works, device must be unplugged or breaker must be turned off.
- * Aluminum cassette filter holds powders and oils in the air.
- * Metal filter should be washed with a hot water with soap or if possible, in the dish washer once a month (in 60°C).
- * Remove Aluminum cassette filter in by pressing spring latches on its edges. After cleaning, do not remount without thoroughly wiping.
- * External surfaces of aspirator should be wiped with a damp cloth, which is wetted with water with soap or alcohol.
- * Avoid contact between electronic parts with water or similar liquids.
- * Using Inox cleaner and maintenance products, which are sold for Inox products in the market, provides your product to have a longer life.

ALUMINUM CARTRIDGE FILTER:

Aluminum cassette filter holds powders and oils in the air. Metal filter should be washed with a hot water with soap or if possible, in the dish washer once a month (in 60°C).

REMOVING ALUMINUM CARTRIDGE FILTER:

Remove Aluminum cassette filter in by pressing spring latches on its edges. (Figure 6)
Do not remount without thoroughly wiping.

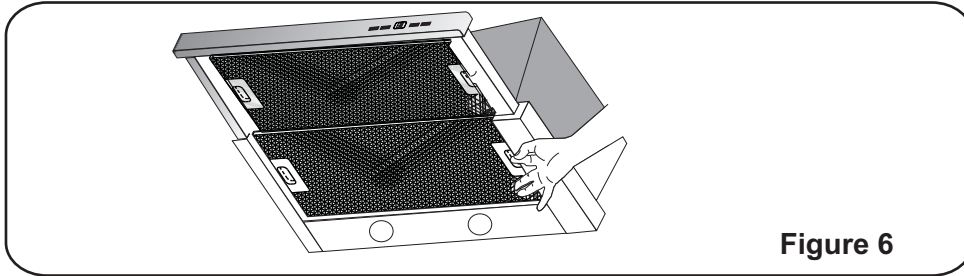

Figure 6

If you need transporting;

- * Keep the original package. Handle with original package. Comply with the carrying signs on the package.

If there is no original package;

- * Do not put weight on aspirator.
- * Protect the external surface from impacts.
- * Carry the product by packing against damages and losses.

UYARI VE EMNİYET TEDBİRLERİ

- * This product is designed for domestic use.
- * Usage voltage of the device is 220-240 Volt-50 Hz.
- * A grounded plug is installed in your device. This cable must definitely be plugged in a grounded plug.
- * All the electric installation must be done by a qualified electrician.
- * Installations done by unqualified people may result in low performance, defaults in the device, and accidents.
- * Do not let the cable get stuck or squeeze in installation.
- Do not pass the network cable next to the hob; otherwise, it may result in melting the cable, and thus, fires.
- * Do not plug in the device before completing the installations.
- * In order to cut the power of the device in an emergency case, provide the plug in a convenient place where it would be reached easily.
- * If the lamps of your device are worked for long time, do not touch them. Lamps may burn your as they will be hot.
- * Kitchen hoods are designed for cooking in household. There is a risk of failure if it is used for other purposes, and it shall be deemed out of warranty.
- * Comply with local laws and provisions related with discharging stack air. (This warning is not viable for uses with no stack).
- * Flammable foods must not be cooked under the device.
- * After placing pans or pans on your hob start the device. Otherwise, high temperatures may result in deformation of parts in the device.
- * Do not leave hot oil on the hob. Pots that contain hot oils may result in ignition, thus fires.
- * While making fried foods, take care of curtains and covers. They may catch fire. Be careful.
- * Turn off the hood before taking pots or pans off the hob
- * Change the filters in regular periods. Oil residues may form critical fire risks.
- * Do not use instable filtering materials instead of original filters.
- * Do not use the device without filter. Do not take out the filters while the device is working.
- * If there is ignition or spark cut the electric power in the device. (Cut the electric current by unplugging).
- * If the device is not cleaned regularly grime and dirt may form fire risks.
- * Cut the power of the device before starting maintenance procedures. (Cut the electric current by unplugging).
- * The negative pressure in the kitchen must not exceed 4 Pa (4 X 10 bar) while the electric hob; hood and other devices fed with electric power are working at the same time.
- * Exhaust of machines working with fuel oil or gas fuels, such as floor-central heating system, must be totally isolated or hermetic type.
- * When you make the stack installation for our device, use 150/120 mm pipes. The stack installation must be as short and without bends as possible.
- * Keep the packing materials away from the children, as they may expose danger for them.
- * Ensure that your children do not play with the device. Do not let little children use the device.
- * If the feeding cable is faulty, this cable must be changed by the manufacturer or its service agent or qualified personnel of same rank.
- * If there is a flaming, cut the power of aspirator and cooking device and cover the flame. Do not use water to extinguish fire.

Use "MAX 6 A" fuses in the aspirator installation in order to secure your safety.

Warnings About Handling and Carrying

- * All the materials used in the packing of your device are suitable for recycling.
- *Comply with the warning labels on the packs during transportation.
- *Grab handling places while carrying your device.

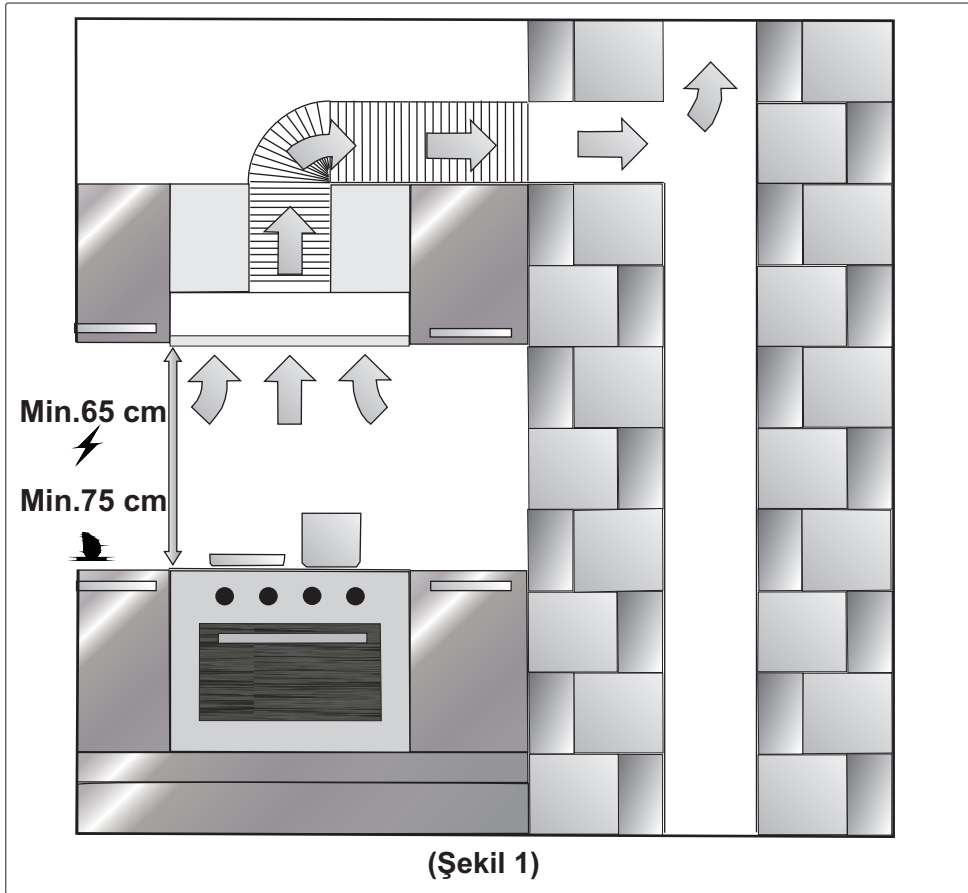

PLACE OF THE DEVICE:

The aspirator is mounted to the cabinet on upper side; and to wall at back. When the installation is completed there must be an interval at least for 65 cm between the hood and hob. There must at least 75 cm interval between the hood and the hob working with gas or other fuels.

MAKING THE ELECTRIC CONNECTION OF DEVICE

A grounded plug is installed in your device .This cable must definitely be plugged in a grounded plug in a grounded plug.

OPERATION OF CONTROL PANEL

Speed Selection

Device has 3-step ventilation. (Figure 1).

One of the ventilation steps 1,2,3,.....5 is selected according to steam of cooking and frying. The engine on the front side is operated by pushing control buttons. Models with electronic remote control have automatic timer (TIMER).

TIMER

If you press on the button with clock sign for longer than 2 seconds, a timer with 15-minute function will be activated. And the display will sign and the motor will automatically stop after 15 minutes. Please start the cooker at the same time in order to provide air circulation. In this way, the absorption power will be supported. After the cooking is over leave the device working for short time, so the remaining smell and steam will be absorbed.

TOUCH BUTTON POSITIONS

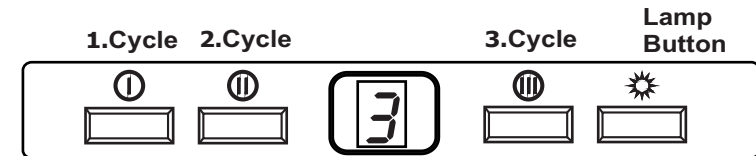

Illumination

There are 2 pieces of lamp on the product and one lamp button in order to command the illumination. Press lamp button in order to operate the illumination.

Cleaning Periods of Metal Filters:

It should be cleaning once in 2-3 weeks subject to operation or when "C" signal appears on the Display. After filters are cleaned and assembled into the place, in order to delete "C" signal, press ① button for a period, longer than 3 sec. "E" letter shall appear on the Display and it shall be passed to the normal operation. In case it is demanded to continue operation before deletion of "C" signal, when you press ① button, active cycle shall appear for 1 sec. period, "C" signal shall appear again and operation of motor shall continue.

NOTE: "C" sign will appear after 60-hour use.

Replacing the lamps

Cut the electric current of the hood.
Remove the aluminum cassette filter.

50W Halogen

In order to replace the halogen lamps press the lamp starter towards below, and twist it in counter clockwise. And remove it downwards. Twist it in counter direction while fixing in. Remove the faulty lamp and replace a lamp that is the sama power. turn in counter clocwise while mounting.

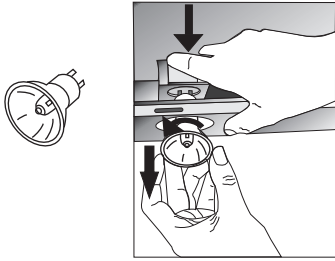

Plug lamp

Remove the faulty lamp and replace a lamp that is the sama power

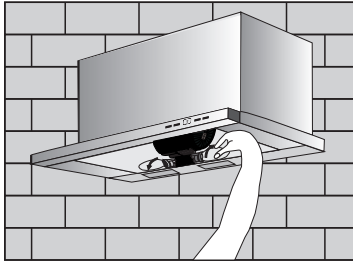

Note: You may provide the lamps from Authorized Services.

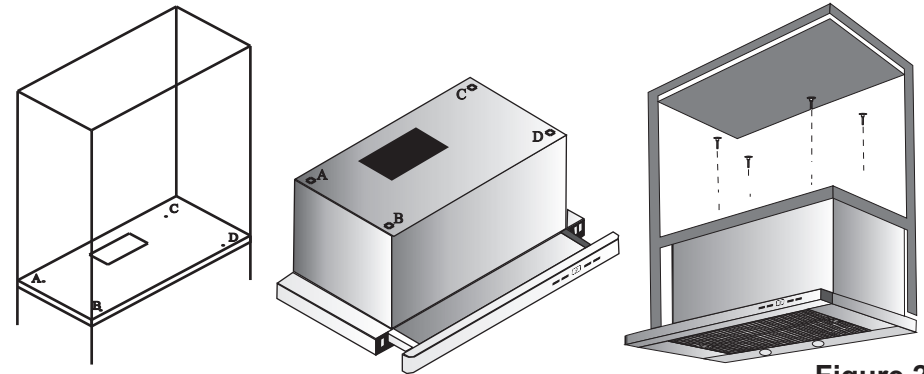

Figure 2

ASSEMBLY UNDER THE CABINET (Figure 2)

Drill 4 holes on the plate under cabinet by using assembly template. Make a stack exit, which is wider than 150 mm on this wooden plate by using assembly template. Mount the device by using the 3,5x45 screws provided with the product. When the sliding set moves, front panel must not rub against cabinet cover.

Standard Accessories (Figure 3,4)

- * Assembly template
- * Assembly screws
- * Recycling system NR-V stack exit component (Figure 1)

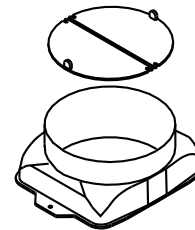

Figure 3

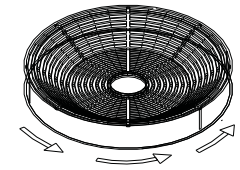
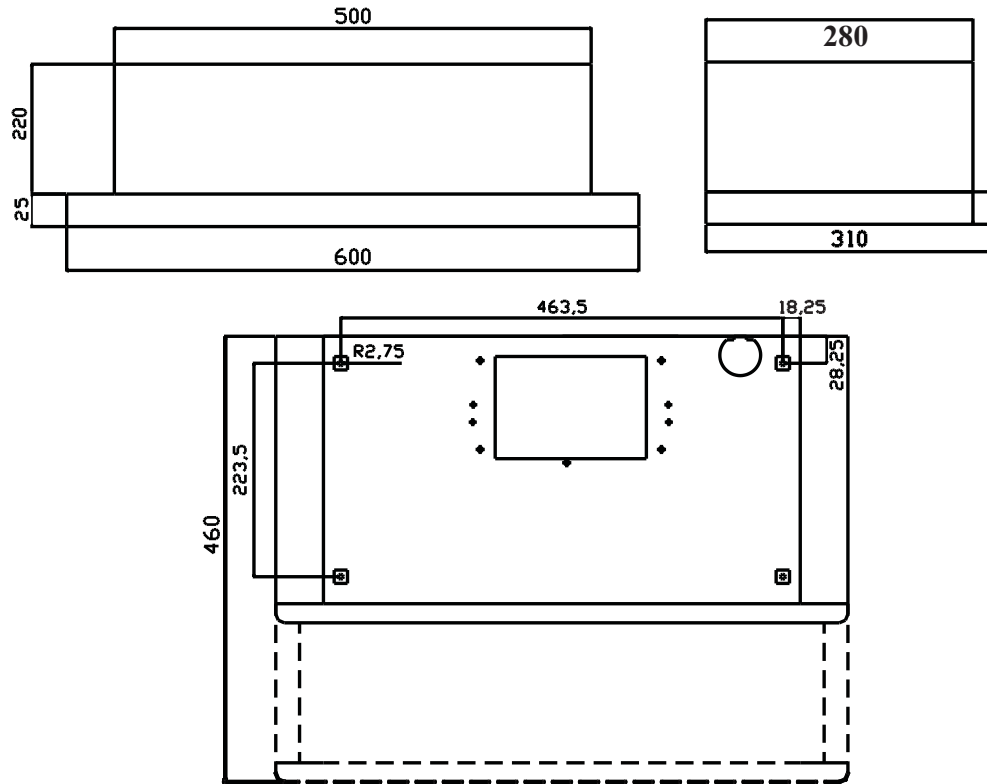

Figure 4

DESIGN OF THE ASPIRATOR



(Figure 5)

CARBON FILTER USES:

Use of carbon filter is as follows.

Before replacing Carbon filter, disconnect the power of your device. The carbon filter is placed at the back of the metal filter. Push metal latches and remove the metal filter in order to remove the carbon filter.

Ensure that your device is completely unplugged.

As Carbon filter is used in the kitchens, which do not have chimney outlet, it should be replaced once in each 3-5 months depended on the usage. Do not use your device without oil filter.

CARBON FILTER CHANGE (Figure 5);

There are 2 pieces of carbon filter used in the device. Turn counter clockwise in order to remove the carbon filter.

FUNCTIONS OF THE DEVICE;

Aspirator may be used in kitchens with or without stacks.

In uses with stack;

Air exit is provided by coupling a 120/150 mm > flexible, compliable pipe between the device and stack. N-RV (No Return Valve) prevents the return of gases and air flows to the kitchen.

WARNING!

Aspirator exit must not be connected to air channels that smoke and fumes are circulated.

IN USES WITHOUT STACK;

Air may be re-circulated to the kitchen by being filtered with two carbon filters by means of 120/150 mm > pipe and N-RV stack through the cabinet. This method may be applied in kitchens where there is no chimney exit.